

Microwave antenna

AL4-24/MP



Microwave antenna description

High Performance 1.20 m antenna for point to point links.

General parameters

| | |
|---------------------------|------------------------------|
| Diameter | 1.2 m (4 ft.) |
| Feeder | dual polarized |
| Input flange standard | circular, hole diameter 8 mm |
| Polarization | dual |
| Environmental temperature | -45 °C ÷ +55 °C |
| Color | gray |
| Radom material | plastic tilt |
| Radom color | white |

Electrical parameters

| | |
|----------------|--------------------------|
| Frequency band | 24.000 - 24.250 GHz |
| Gain mid band | 46.8 dBi |
| 3dB - BW | 0.8° (H/ V) |
| Return loss | > 1.20 (20 dB) |
| F/B ratio | 73dB |
| XPD | 32 dB |
| Class | 2 or 3 (ETSI EN 302 217) |

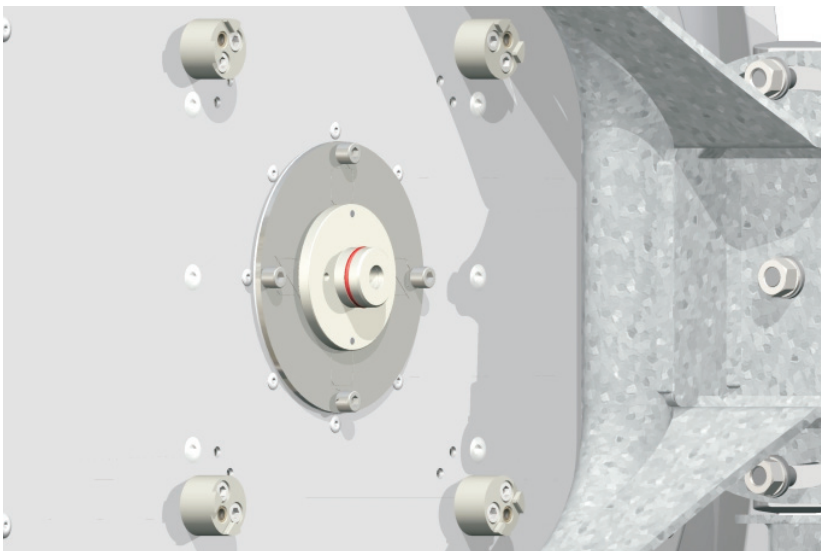

Microwave antenna AL4-24/MP

Mechanical parameters due to wind

| | |
|-----------------------|-------------------------|
| Performance stability | up to 30 m/s (110 km/h) |
| Survival | up to 55 m/s (200 km/h) |
| Net weight | 34 kg |
| Pipe diameter | 101 - 115 mm |
| Fine adjust Azimuth | $\pm 7^\circ$ |
| Fine adjust Elevation | $\pm 15^\circ$ |

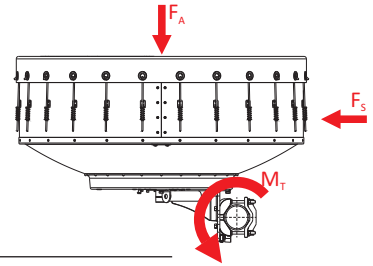

Forces and twisting moment due wind and ice

| Wind velocity | 30 m/s (110 km/h) | 55 m/s (200 km/h) |
|---|-------------------|-------------------|
| F_a - axial force | 870 N | 2850 N |
| F_s - side force | 320 N | 1030 N |
| M_T - twisting moment | 350 Nm | 1150 Nm |
| Vertical load due to radial ice 25 mm (ice density 7kN/m ³) | | 670 N |

Outlines

